



Coventry and Warwickshire

Champions



Adam Dent, Advent Communications

The background features a dynamic, abstract composition of numerous 3D-style rectangular bars. These bars, in various colors including blue, red, yellow, green, and purple, radiate outwards from a central point, creating a sense of movement and depth. The bars are layered and overlap, giving the impression of a complex, multi-dimensional structure.

Patrick Derham - Rugby School



Rugby School



Coventry and Warwickshire

Champions

Stand 14.09
Coventry and Warwickshire

Stand 14.09
Coventry and Warwickshire

Stand 14.09
Coventry and Warwickshire

Stand 14.09
Coventry and Warwickshire

Coventry and Warwickshire QI

Come along to our version of the highly successful TV quiz especially themed around Coventry and Warwickshire. It's your chance to hear about the known and slightly less known opportunities for innovating, investing and inspiring in both city and county. You never know it might be Quite Interesting!

Your panel members are:

George Gillespie, CEO, MIRA Ltd (Motor Industry Research Association)

Richard Hutchins, Director, Jaguar Land Rover Programmes, WMG & Director, WMG Academy for Young Engineers

Les Ratcliffe, Head of Community Relations, Jaguar Land Rover

Cllr Ann Lucas, Leader, Coventry City Council

Cllr Lynnette Kelly, Cabinet Member, Business Enterprise and Employment, Coventry City Council

Martin Yardley, Chief Executive, Coventry and Warwickshire Local Enterprise Partnership

Hosted by John Till founding Director of thinkingplace, the UK's only place specialist company

Thursday 13th March, 9 - 10am

Coventry and Warwickshire Apartment - No3, La Croisette

Please RSVP to sarah.perry@coventry-warwickshire.co.uk



Coventry & Warwickshire
Local Enterprise Partnership





Coventry and Warwickshire

Influential

Home to a number of leading companies such as E.ON, Jaguar Land Rover and Severn Trent
Major centre for the games industry

evian

Martin Yardley
Warwickshire LEP

warwickshire.co

ZLDTZ

ZLDTZ







Conference Coventry and Warwickshire



RICOH ARENA

CoventryTe

warw



Coventry International Prize for

Peace and Reconciliation



14 November 2014



Coventry
University





Tim Martin – ADV Manufacturing Ltd

C&W champions presentation



ADV Manufacturing Ltd

Tim Martin

Managing Director

26th March 2014



History/background

- **Initially established to manufacture premium automotive brightwork**
 - Formed in 2010 under CPP (Coventry Prototype Panels Ltd)
 - Took over from two failed businesses who had supplied Bentley and Aston Martin
- **From its CPP heritage, our project teams have built many automotive icons**
 - Queen's own limousine
 - Supercars for Spyker & Aston Martin
 - Bentley Continental Zagato coupes
- **Now fully independent - annual sales of £15 million, growing fast**
 - 80% to Bentley, Aston Martin, JLR, Nissan & Rolls-Royce
 - 20% to aerospace & bespoke commissioned products
 - 180 employees on 11 acre industrial site
 - Accredited to ISO9000 & ISO/TS16949 quality standard



Site location

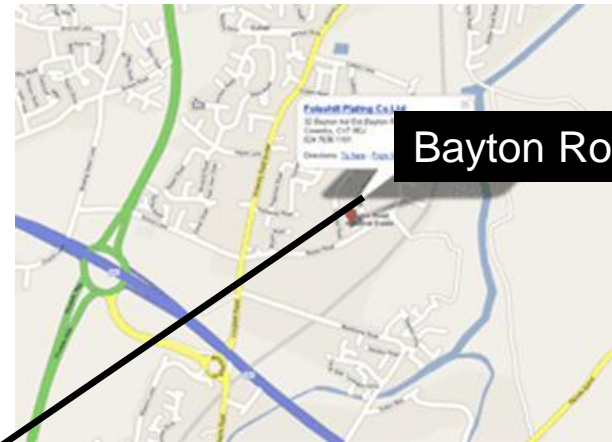
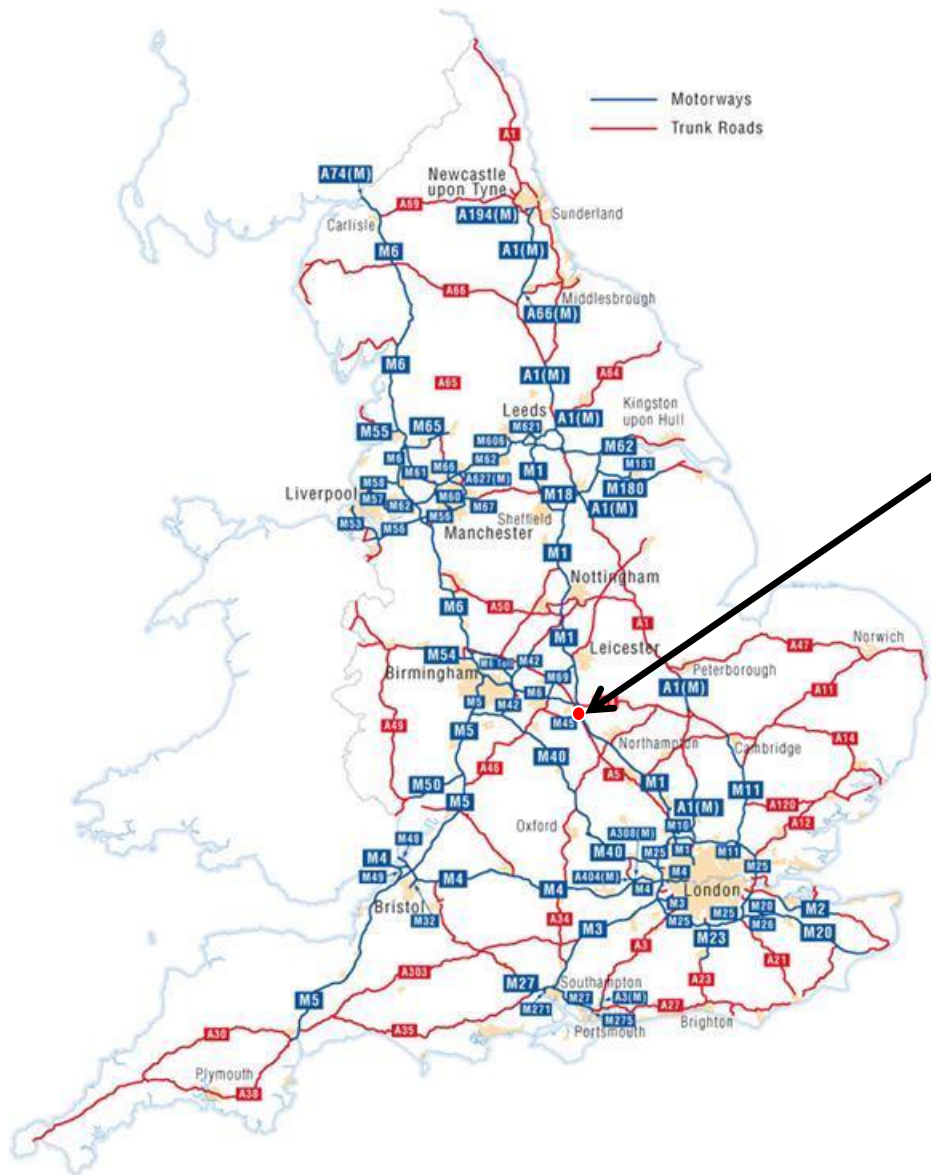

Current in-house capabilities

- **CAD based product design, tooling & process development capability**
 - Mechanical & hydraulic presses up to 600t capacity
- **Extensive prototype studio**
 - Metalworking craftsmen of the highest skill levels
- **Comprehensive metal forming facilities**
 - Presses up to 600t, roll forming, stretch bending, multi-axis CNC machining & laser cutting/welding equipment
- **Craft skills to mirror finish stainless steel & aluminium based decorative products**
 - Backed up by modern robot polishing/finishing cells
- **Assembly of low to medium volume products and vehicles**



So, what is ADV all about?

- Craft skills allied to modern automation
- Premium cosmetics - polished brightware
- Bespoke manufacturing – including full vehicles
- Leveraging automotive skills into aerospace
- Developing EV technology



‘Coachbuilding for the next generation’

It's what we do ...



**Mirror finished
stainless steel
takes a lot of
work & skill!**



Company startup – Aug'10

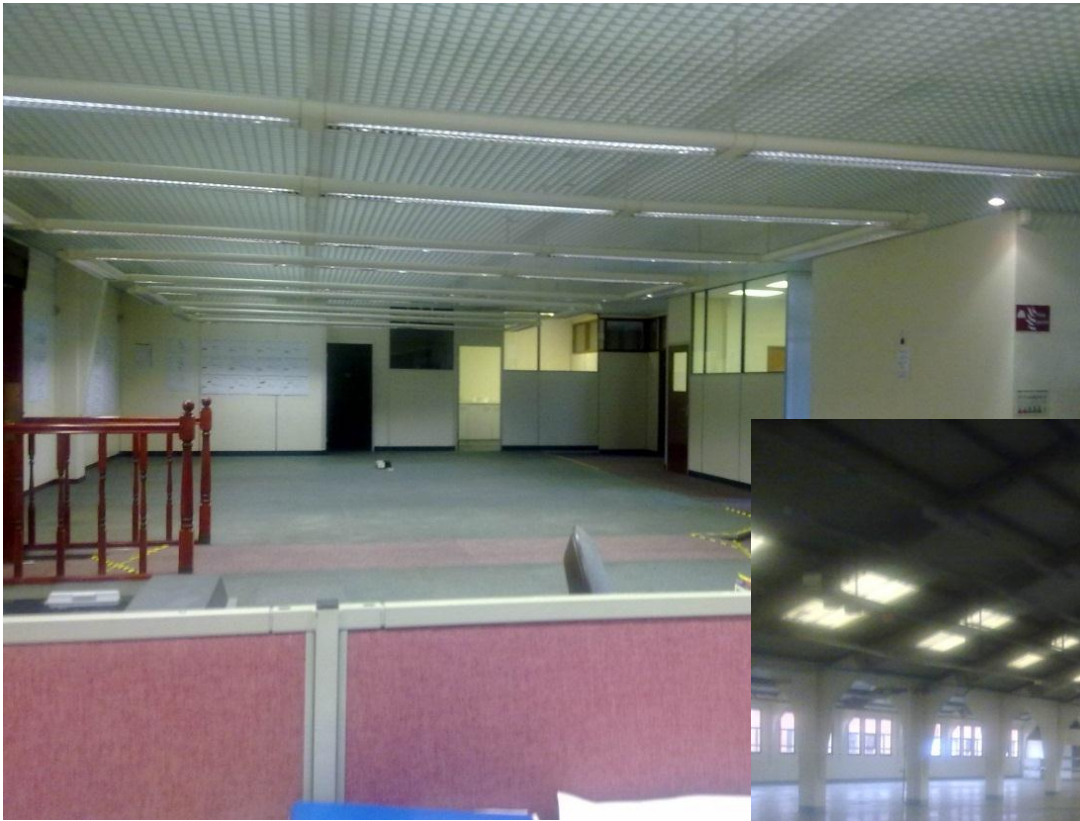

Company evolution – Mar'14



Automotive – Aston Martin

Boot finishers

Waist level trims

Cantrail trims

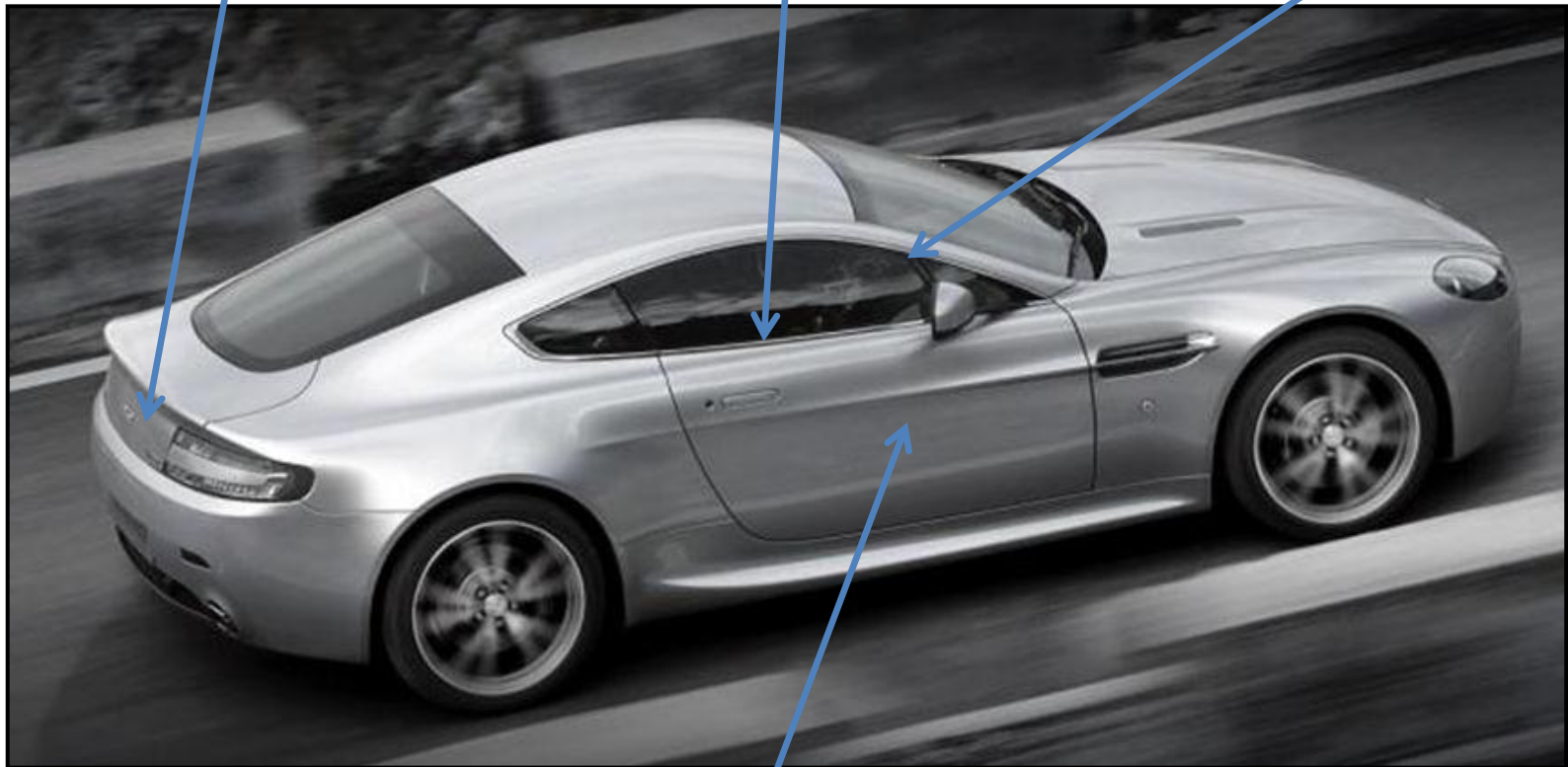

Complete door assemblies

Automotive – Bentley

DLO seal structures/trims, “B & C” post trims, Waist level door finishers

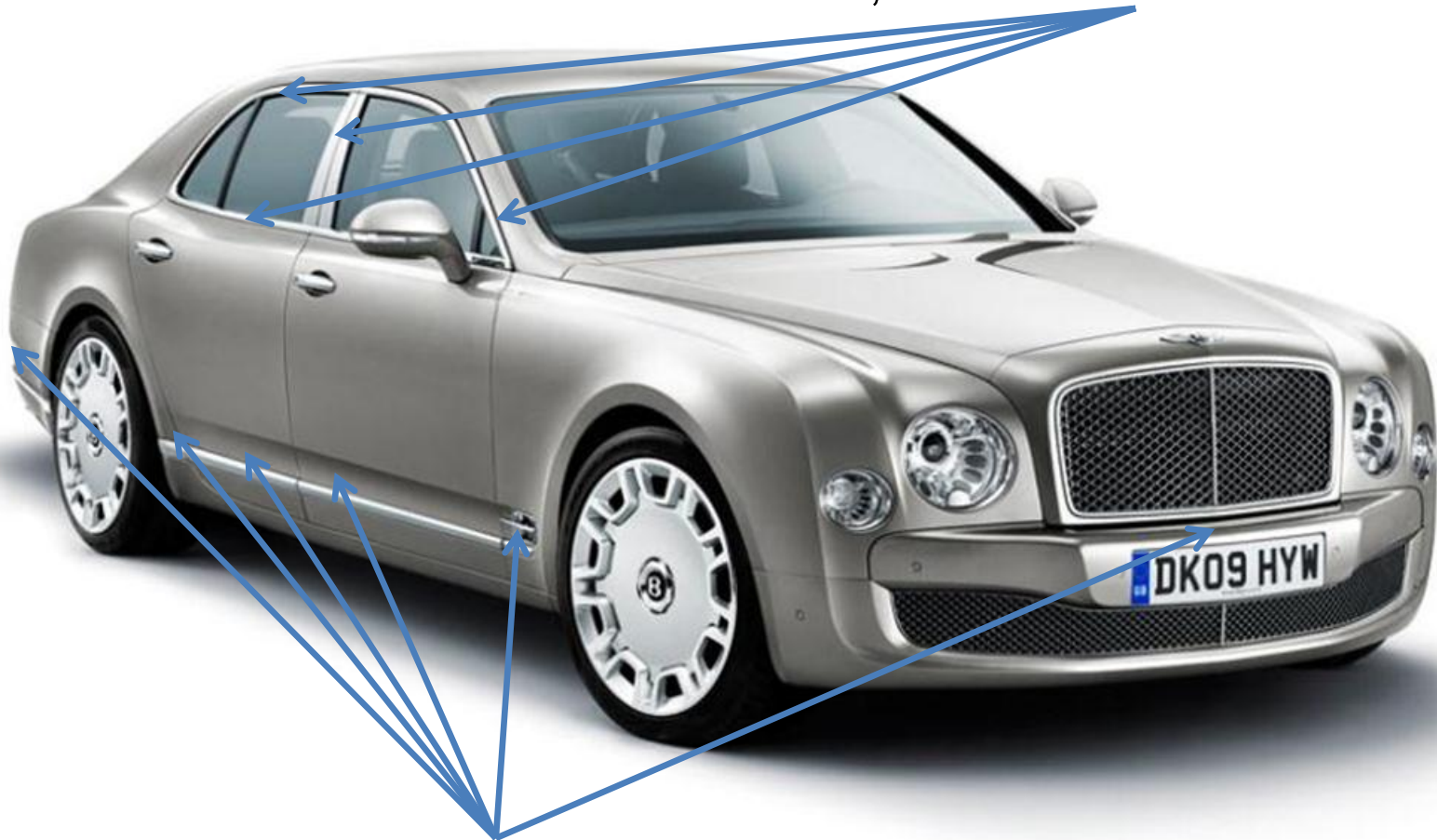

Bumper & body appliques, DLO seal structures & trims, “B & C” post trims, Waist level door finishers

Tonneau brightware



- Including assembly with
- Centre high level stop light
 - Plastic mouldings
 - Seals & fixings

WATERSPEED



Interior decorative trims



Aerospace seating system

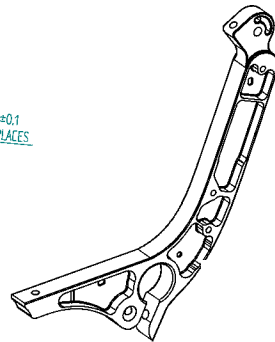
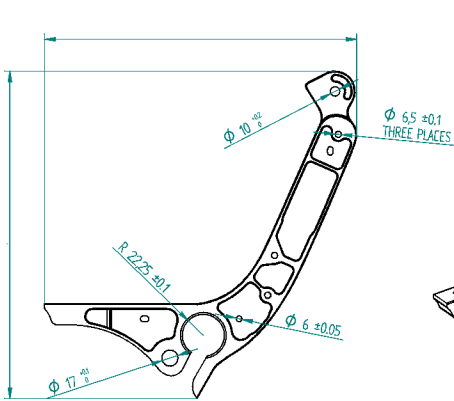

Business jet - interior trim



Plant & equipment



Quality measurement

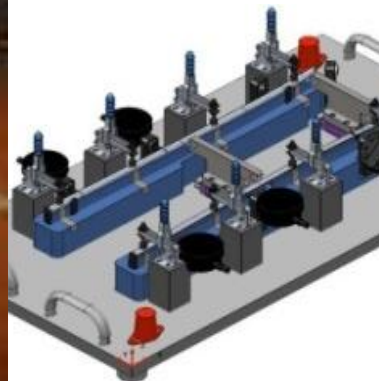

Welding processes



Projects



Silk
ENGINEERING SOLUTIONS

SILK ENGINEERING LTD - CONTACT TEL: -EMAIL

Based in the Midlands

A row of logos at the bottom of the slide, including a stylized 'S' logo, a logo with 'SILK ENGINEERING LTD' text, the 'Capgemini' logo, and the 'CENTERS' logo.



Nissan London taxi conversion



And tomorrow.....

- **Regional taxi business plan**
 - UK & Continental Europe
 - By end 2015, ADV expects to have built & sold over 2,000 vehicles
- **Lightning GT all electric supercar**
 - Bespoke manufacturing of transformational EV with 10 minute recharge capability
- **The House of Silk - strategic alliances with**
 - DesignQ - the design studio for Bombardier, the World's largest business jet maker
 - Millbrook Proving Ground
 - Altair – global leader in CAE/structural engineering services
 - More strategic alliances will result in 'cradle to grave' bespoke product development & manufacturing
- **NPI Blackbelt with Industry Forum/SMMT**
 - A new nationally recognised qualification in New Product Introduction





Coventry and Warwickshire

Champions



Cllr Craig Humphrey, Rugby Borough Council, CWLEP
Board Director

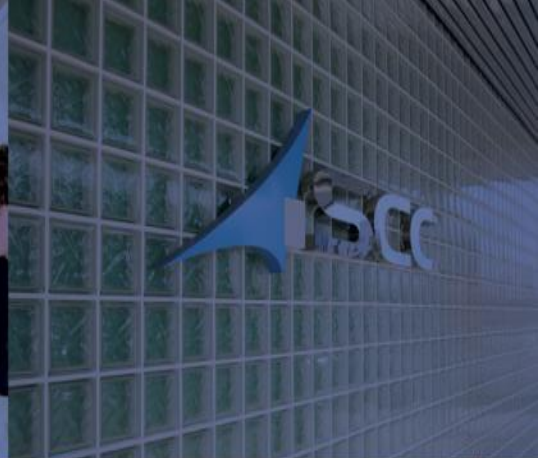

City Deal as presented by CWLEP

INNOVATING.
COLLABORATING.
UNITING.

Designed by the private sector: Facilitated by the LEP.



HM Government



Coventry & Warwickshire
Local Enterprise Partnership



Why Coventry & Warwickshire and Why Advanced Manufacturing & Engineering?

£1.97bn

Value of AME sector in terms of GVA to CW

44,000

Employed in the AME sector in CW

450 Companies

Leaders in this sector produce globally desirable products

5 x UK

Average employment in automotive sector

5

Further education colleges

2

World class universities

2

Catapult Centres

Wealth of unrivalled knowledge transfer assets

R&D

Expenditure concentrated in too few companies. Need to spread the benefit of our research capability

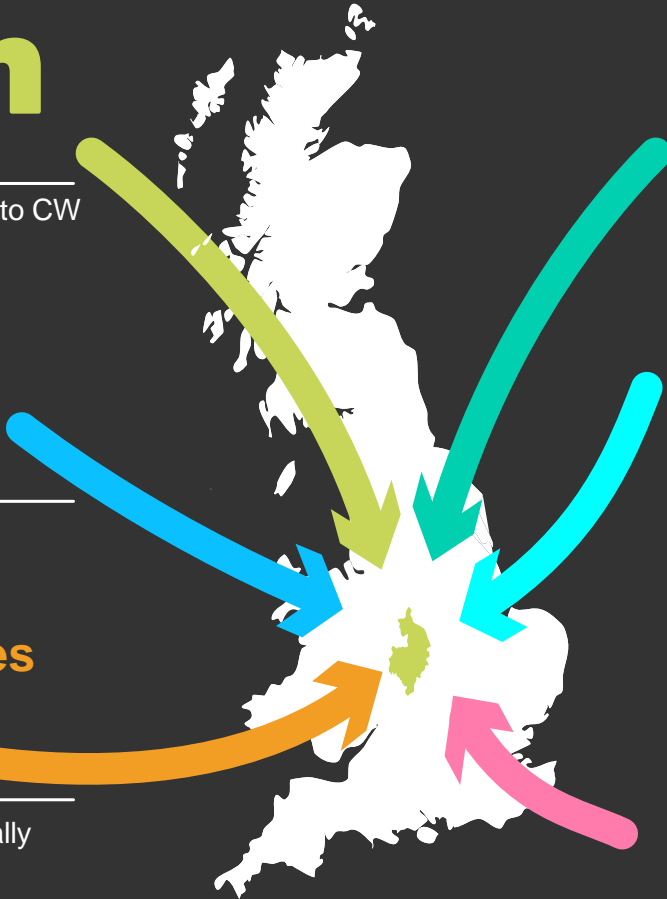



Confused, Crowded, Supplier-led...

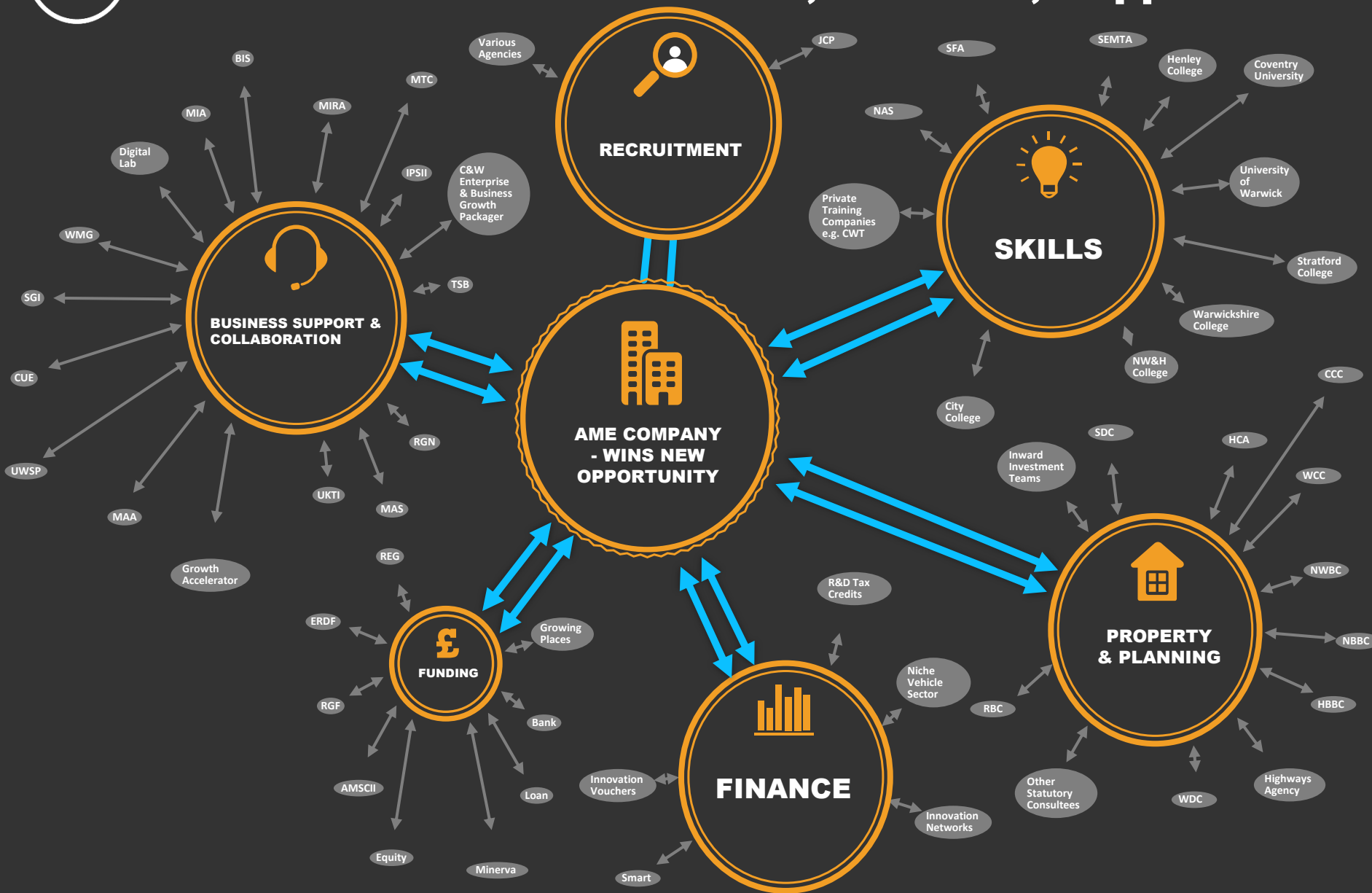



Our Solution – One Point of Contact

LOCALLY MANAGED



**CLEARING HOUSE (Business Growth
Hub)**

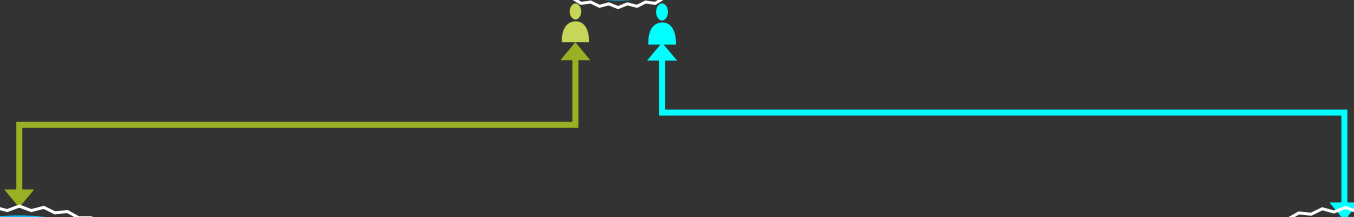



Coventry & Warwickshire
Local Enterprise Partnership

RESULT



**Our Solution –
One Point of Contact**

LOCALLY MANAGED



CLEARING HOUSE (Business Growth Hub)





- 1st April, Clearing House Web Presence at - www.cwclearinghouse.co.uk
- 1st April, email on contact@cwclearinghouse.co.uk
- April to June 14, Commissioning and Development of Clearing House Portal and CRM, overseen by Kevin Malone, Director of ICT, City Council.
- 1st April 14, Core Systems and Processes in Place to record, report and monitor the work undertaken with AME Companies.
- Unique database of 1348 AME Companies.
- From 1st April, our CH will be client and KPI focused, notably 'response times', 'brokerage work' and 'value added'.





Physical Infrastructure

- 1st April. Clearing House Team in place and operating out of interim space, Chamber House.
- From 1st April, Clearing House Contact Centre in-place, **Telephone Number 0300 060 3747. “Six Rings” Response.**
- From 1st May 14, Cheylesmore House, License to Occupy in place.
- From 1st June 14, Cheylesmore House ready for occupation by Core Team and Partners.
- **ICT Connectivity in place – Level 3 Communications.**





Coventry & Warwickshire
Local Enterprise Partnership

CW LEP Board Support

Soft Launch of Clearing House on 10th April 2014

Event for >100 AME Companies at Warwick Manufacturing Group

'Please Feel Free To Join Us

City Deal & Clearing House – 18 Months in Development – 10 weeks to get up-and-running and delivering!

THANK YOU FOR YOUR SUPPORT



Coventry and Warwickshire

Champions

The background is a complex, abstract composition of overlapping, semi-transparent geometric shapes and lines. The colors are vibrant and varied, including shades of blue, red, yellow, green, and black. The shapes appear to be layered, creating a sense of depth and movement. A prominent red banner is overlaid on the scene, containing the text 'James Noble, Motofest'.

James Noble, Motofest

Coventry MotoFest 2014



Coventry MotoFest 2014

- 30th May – 1st June
- Historic Vehicle displays
- Future Technology demonstrations
- Ring Road circuit cavalcades
- Coventry University degree shows
- Film Festival
- Ace Cafe London to Coventry run
- Live stage



Coventry MotoFest 2014

You can help make it happen

- Sponsorship
- What can you bring to the party?
- Showcase your business
- Human resource



james@coventrymotofest.com

www.coventrymotofest.com





Coventry and Warwickshire

Champions

Coventry and Warwickshire Champions

Wednesday 21st May 2014

7.45 – 9.30am

www.coventry-warwickshire.co.uk





@CWCHAMPIONS

www.coventry-warwickshire.co.uk



The background features a complex, abstract composition of overlapping, multi-colored geometric shapes and lines. The colors include shades of red, blue, green, yellow, and black, creating a sense of depth and movement. The shapes are primarily rectangular and triangular, some appearing as if they are layered or stacked, while others are thin, sharp lines that intersect and cross each other. The overall effect is a dynamic and modern visual style.

Coventry and Warwickshire

Champions